

**TONBRIDGE & MALLING**  
BOROUGH COUNCIL  
PLANNING, TRANSPORT & LEISURE

Chief Engineer  
**Mike McCulloch**  
BSc(Eng) (Hons) C Eng MICE  
Gibson Building  
Gibson Drive  
Kings Hill  
West Malling  
Kent ME19 4LZ  
Tel: 01732 844622 Fax: 01732 878317

Project Title  
**Phase 5**  
Prohibition of Waiting 'at any time' Proposals

Drawing Title  
**Lower Street**  
Hildenborough

Drawn	Checked	Date
SM		August 2009
Scale	NTS	
Drawing No.	DD/473/3	
	Rev	

REVISED PROPOSAL

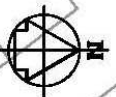

# East Peckham

Reduced limit of proposed restriction

Defer implementation pending further monitoring with Police to assess extent of obstruction parking

Not to be scaled from Plan is for illustrative purposes ONLY

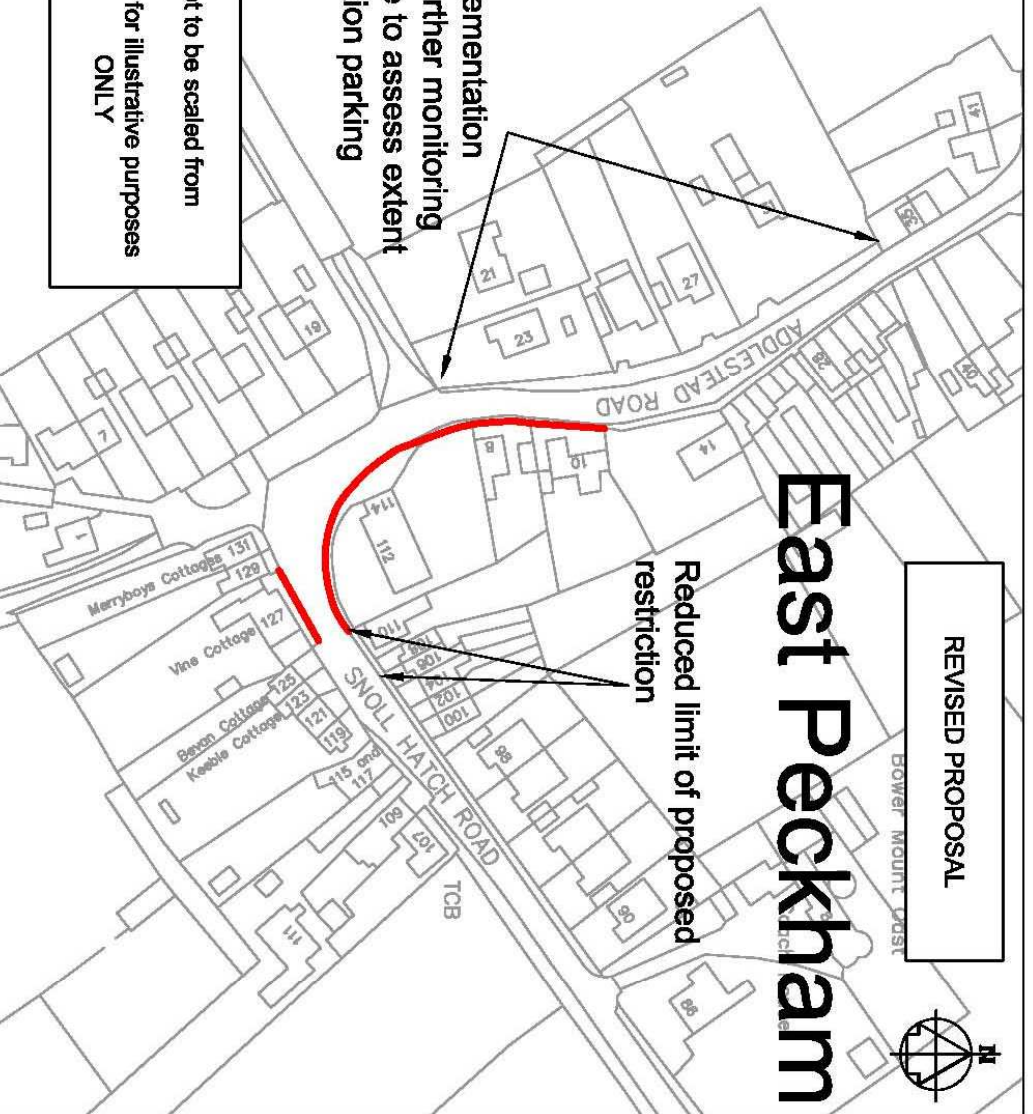

**KEY**  
— Proposed prohibition of waiting 'at any time'

Based upon the Ordnance Survey map with the permission of the Controller of Her Majesty's Stationery Office. Crown copyright. Unauthorised reproduction infringes Crown copyright and may lead to prosecution or civil proceedings. 100033000000



Chief Engineer  
**Mike McCulloch**  
Becken (Home) C Eng MICE  
Gleason Building  
Gleason Drive  
Kings Hill  
West Malling  
Kent, ME19 4JZ  
Tel: 01732 844622 Fax: 01732 878317

Project Title  
**Phase 5**  
Prohibition of Waiting 'at any time' Proposals

Drawing Title  
**Addlestead Road Junction with Snoll Hatch Road East Peckham**

Drawn	Checked	Date
SM		Sept 2009
Scale	NTS	
Drawing No.	DD/493/2	
		Rev

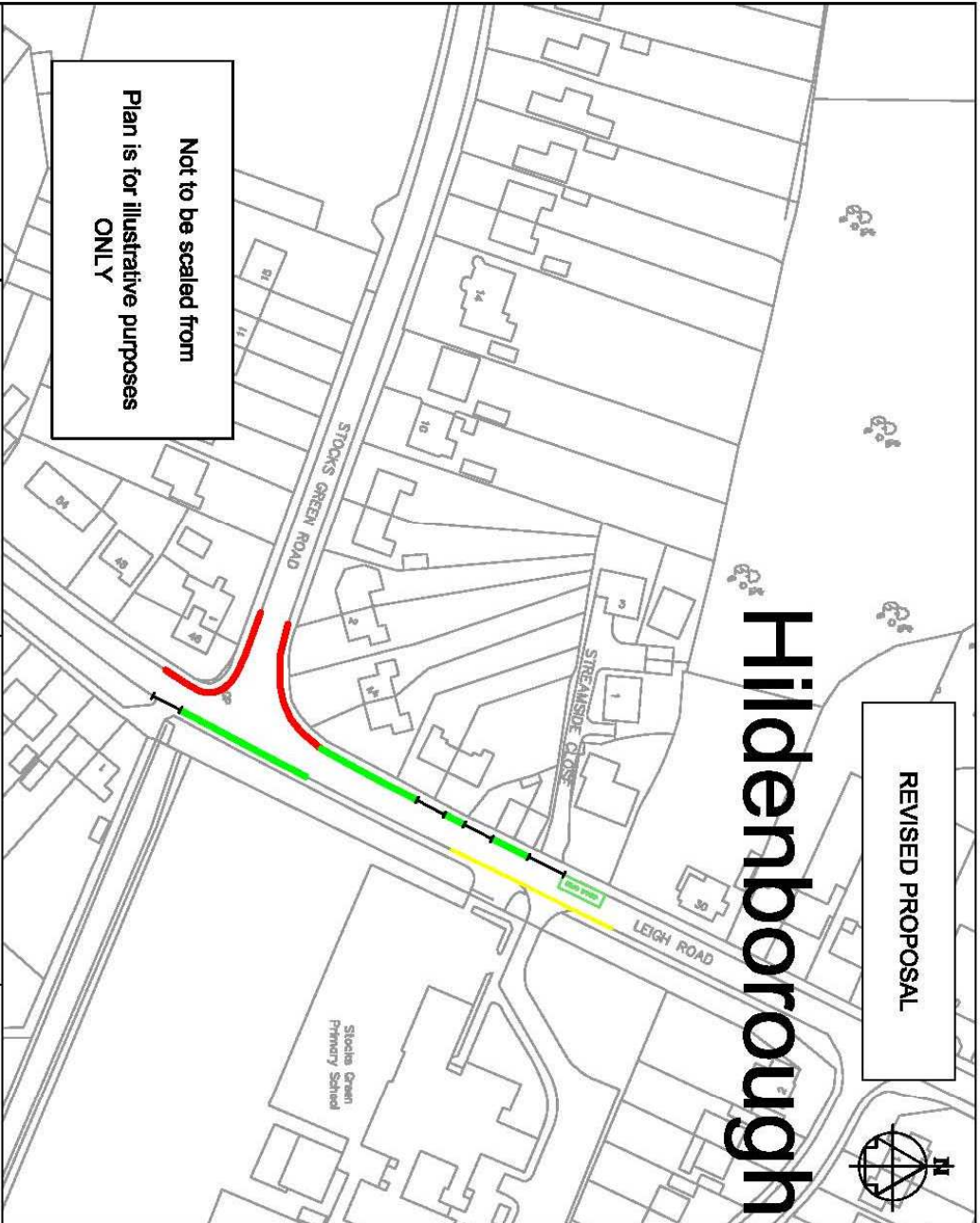

REVISED PROPOSAL

# Hildenborough

## KEY

- Proposed prohibition of waiting at any time
- Proposed waiting restrictions  
Mon - Fri  
8am - 9am and 3pm - 4pm
- Existing School Keep Clear Markings
- Access protection markings
- Existing bus stop clearway

Operational times reduced to  
8am - 9am and 3pm - 4pm  
(from 8am - 4pm)

Not to be scaled from  
Plan is for illustrative purposes  
ONLY



**TONBRIDGE  
& MALLING**  
BOROUGH COUNCIL  
PLANNING, TRANSPORT  
& LEISURE

Chief Engineer  
**Mike McCulloch**  
Becken (Home) C Eng MICE  
Gleason Building  
Kings Hill  
West Malling  
Kent, ME19 4LZ  
Tel: 01732 844622 Fax: 01732 878317

Project Title  
**Phase 5  
Prohibition of Waiting  
Restriction Proposals**

Drawing Title  
**Stocks Green Road and Leigh  
Road  
Hildenborough**

Drawn	Checked	Date
SJM		August 2009
Scale NTS		
Drawing No.		Rev
DD/476/2		

Based upon the Christmas Street meeting with the members of the Committee of the  
Mayor's Advisory Group. Other changes, including suspension of the  
Green signposts and may need to be considered or not proceeded. 100203002000

# Tonbridge

REVISED PROPOSAL



## KEY

— Proposed prohibition of waiting 'at any time'

Based upon the Chairman's Survey meeting with the members of the Committee of the Mayor's Advisory Group, October 2009. All road names are approximate and may need to be amended or not provided. 100233002000

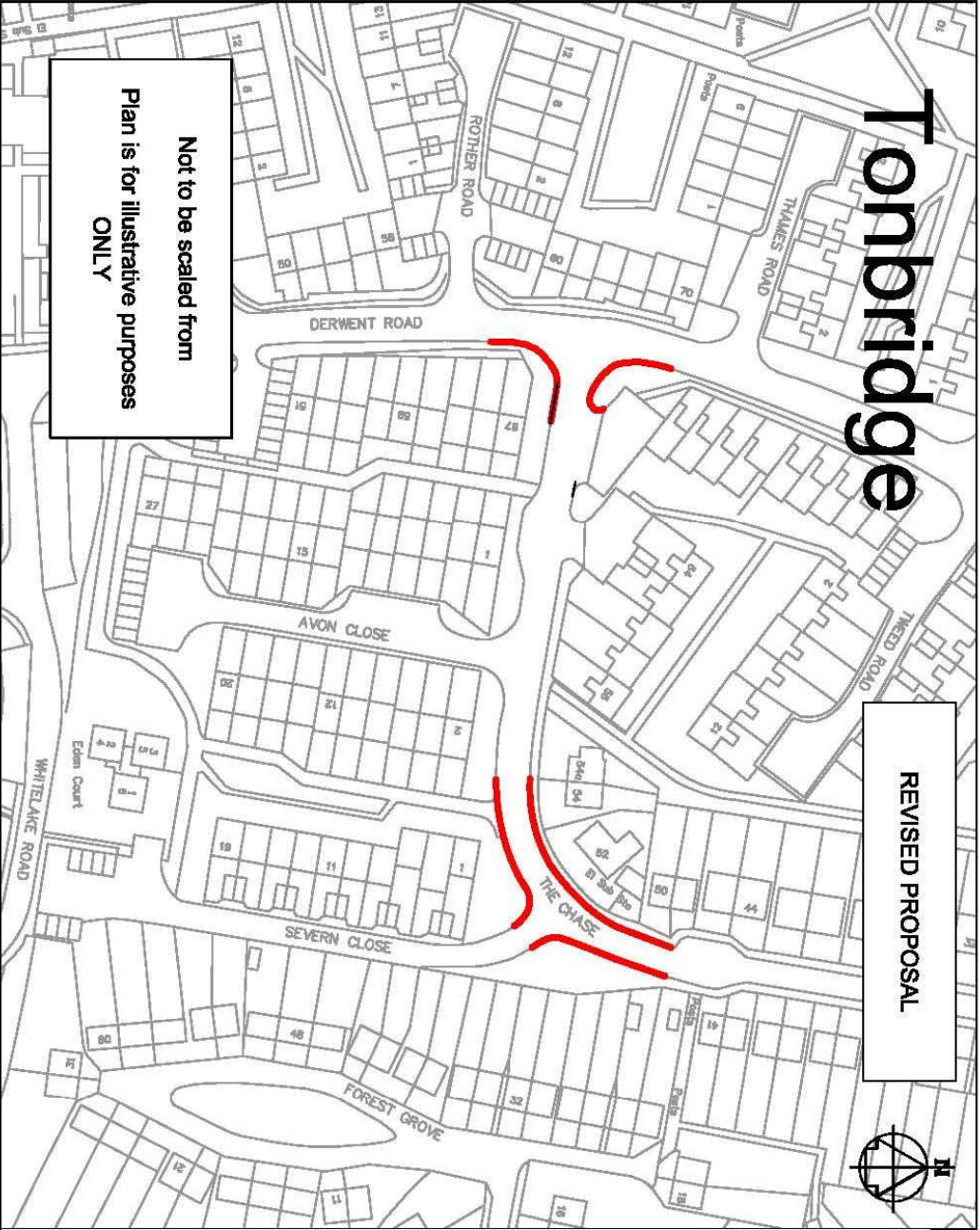

**TONBRIDGE & MALLING**  
BOROUGH COUNCIL  
PLANNING, TRANSPORT & LEISURE

**Chief Engineer**  
**Mike McCulloch**  
BSc(Eng) (Hons) C Eng MICE  
Gibson Building  
Kings Hill  
West Malling  
Kent, ME19 4JZ  
Tel: 01732 844822 Fax: 01732 878317

**Project Title**  
**Phase 5**  
**Prohibition of Waiting 'at any time' Proposals**

**Drawing Title**  
**The Chase Junction with Severn Close and Derwent Road**  
**Tonbridge**

<b>Drawn</b>	<b>Checked</b>	<b>Date</b>
SM		Sept 2009
<b>Scale</b>	<b>NTS</b>	
<b>Drawing No.</b>		<b>Rev</b>
DD/498/2		

# Wouldham

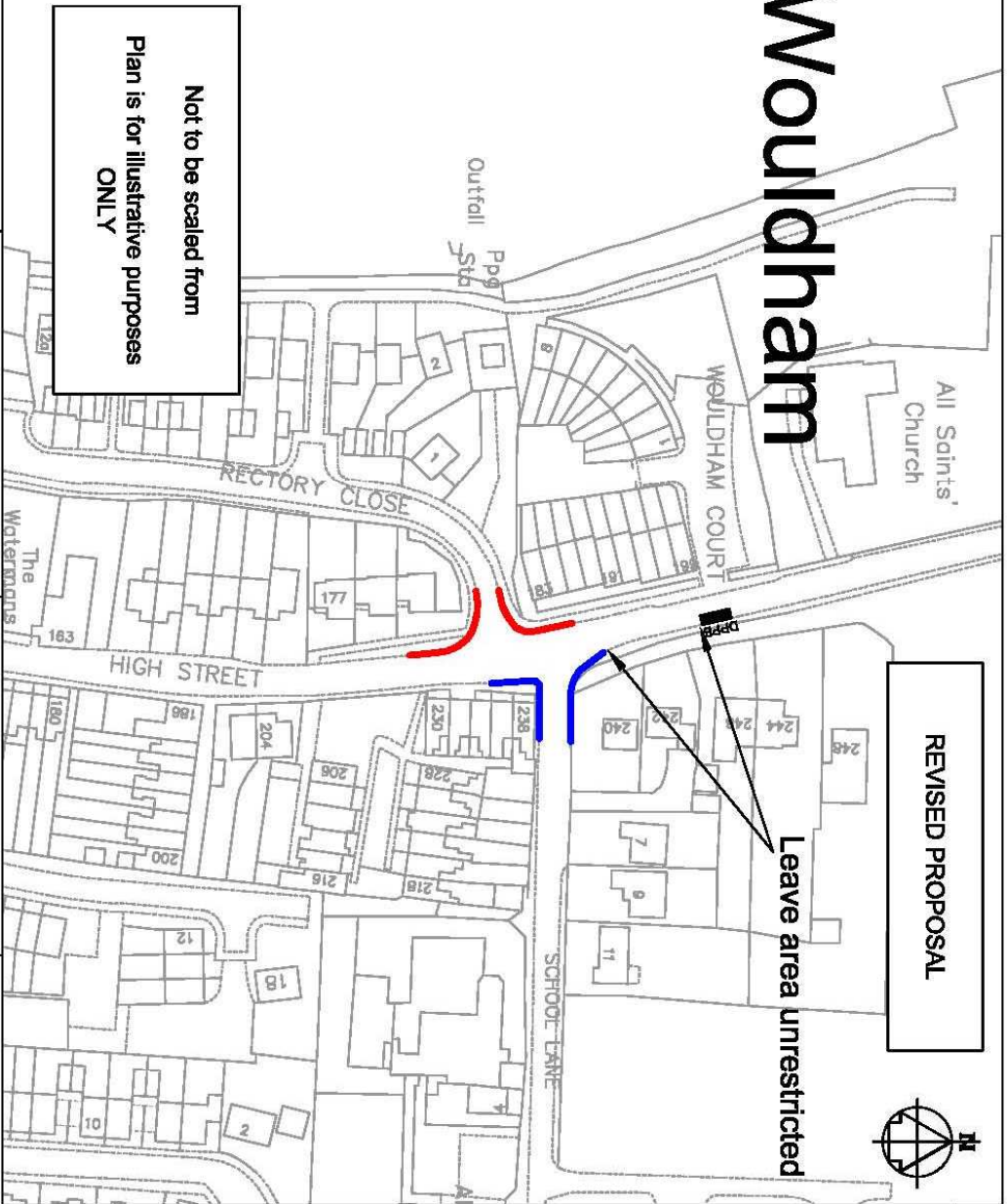

Not to be scaled from  
Plan is for illustrative purposes  
ONLY

REVISED PROPOSAL

Leave area unrestricted



## KEY

- Existing adjacent prohibition of waiting 'at any time'
- Proposed prohibition of waiting 'at any time'
- Existing disabled persons parking bay

Based upon the Ordnance Survey map with the permission of the Controller of Her Majesty's Stationery Office. Ordnance Survey is a trade mark of Ordnance Survey. All other rights reserved. Ordnance Survey copyright and may be used to reproduce or edit drawings. 100023002000



PLANNING, TRANSPORT  
& LEISURE

Chief Engineer  
**Mike McCulloch**  
Becken (Home) C Eng MICE  
Gleason Building  
Gleason Drive  
Kings Hill  
West Malling  
Kent, ME19 4JZ  
Tel: 01732 844822 Fax: 01732 878317

Project Title  
**Phase 5**  
Prohibition of Waiting 'at any  
time' Proposals

Drawing Title  
**Rectory Close junction with  
High Street  
Wouldham**

Drawn	Checked	Date
SM		Sept 2009
Scale	NTS	
Drawing No.	DD/487/2	Rev